

**PIPE BEDDING  
DETAIL FOR SWALES  
1:10**

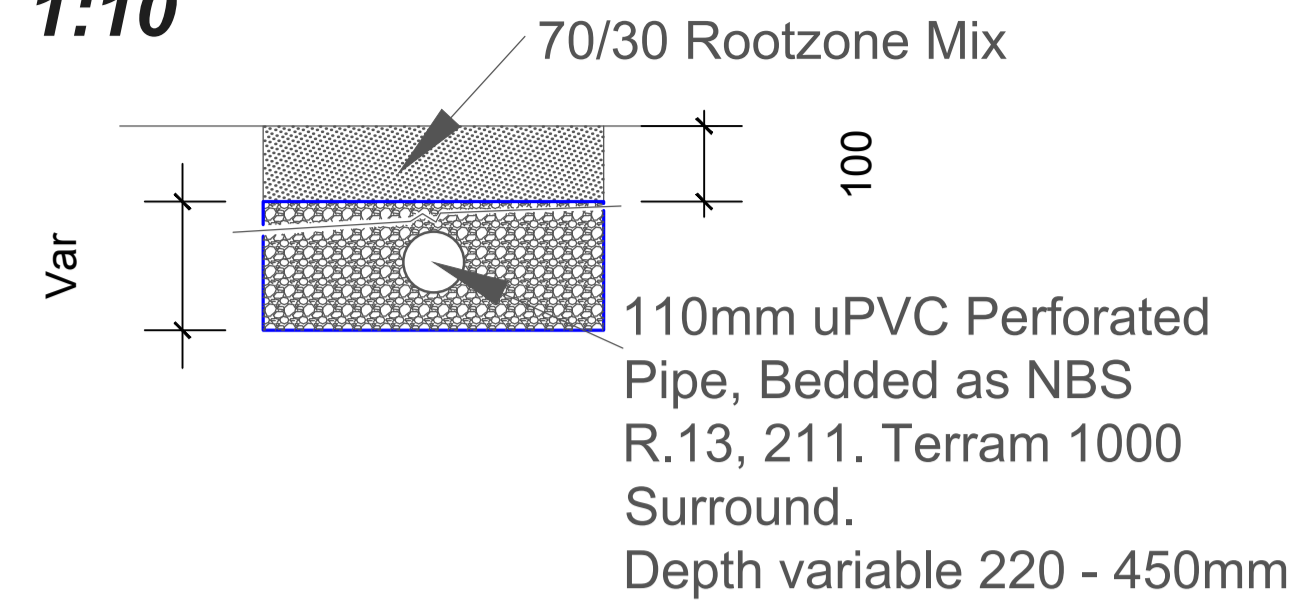

RESPONSIBILITY IS NOT ACCEPTED FOR OTHERS SCALING DIRECTLY FROM THIS DRAWING. DO NOT SCALE FROM THIS DRAWING. USE WRITTEN DIMENSIONS ONLY.

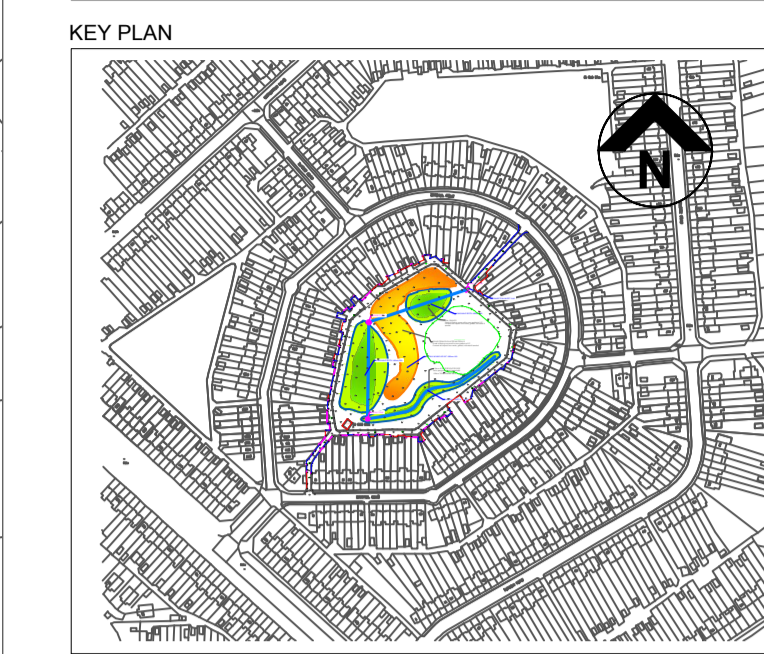
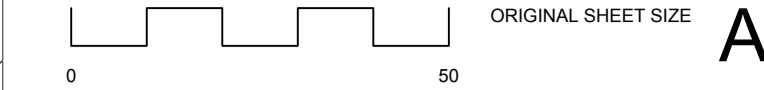

THIS DRAWING IS PRODUCED FOR USE IN THIS PROJECT ONLY AND MAY NOT BE USED FOR ANY OTHER PURPOSE. NPS PROPERTY CONSULTANTS LTD ACCEPT NO LIABILITY FOR THE USE OF THIS DRAWING OTHER THAN THE PURPOSE FOR WHICH IT WAS INTENDED IN CONNECTION WITH THIS PROJECT AS RECORDED IN THE 'PURPOSE FOR ISSUE' AND 'FILE STATUS CODE'.

THIS DRAWING MAY NOT BE REPRODUCED IN ANY FORM WITHOUT PRIOR WRITTEN AGREEMENT OF NPS PROPERTY CONSULTANTS LTD.

© CROWN COPYRIGHT AND DATABASE RIGHTS 2017 ORDNANCE SURVEY LICENCE NUMBER 100019567

Notes:

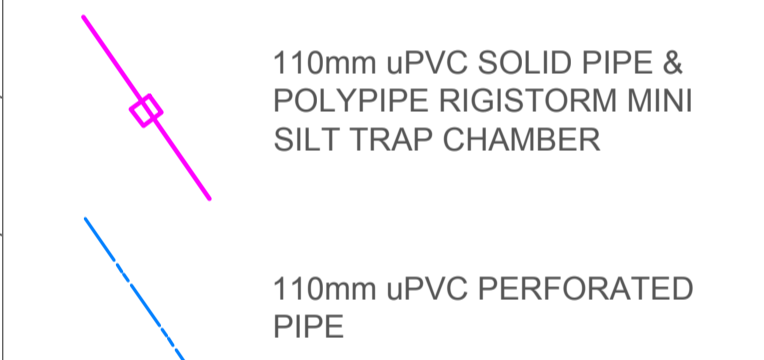

AS-BUILT	AB	pc	10/5/2017	SL	10/5/2017
----------	----	----	-----------	----	-----------

in partnership with

COMMENT	P4	pc	24/10/16	HG	24/10/16	
REV	DRAWN	DATE	CHECKED	DATE	APPROVED	DATE

NPS Humber Ltd  
Earle House, Colonial Street, Kingston-Upon-Hull, East Yorkshire, HU2 8JY.  
Tel: 01482 334477, Email: hull@nps.co.uk, web:www.nps.co.uk

CLIENT  
**KHCC**

PROJECT  
**Bristol Road Flood Alleviation**

TITLE  
**As-Built Drawing**

SCALES	DISCIPLINE	PROJECT NUMBER
1:250	LAND ARCH	16-1-1378

DRAWING NUMBER	REV CODE	
<b>NPS-00-00-DR-L - 803</b>	<b>C1</b>	
STATUS CODE	PURPOSE OF ISSUE	DRAWN BY
AB	AS BUILT	pc/bj

