

### 4.3.2 Draft Proposal General Arrangement Plan

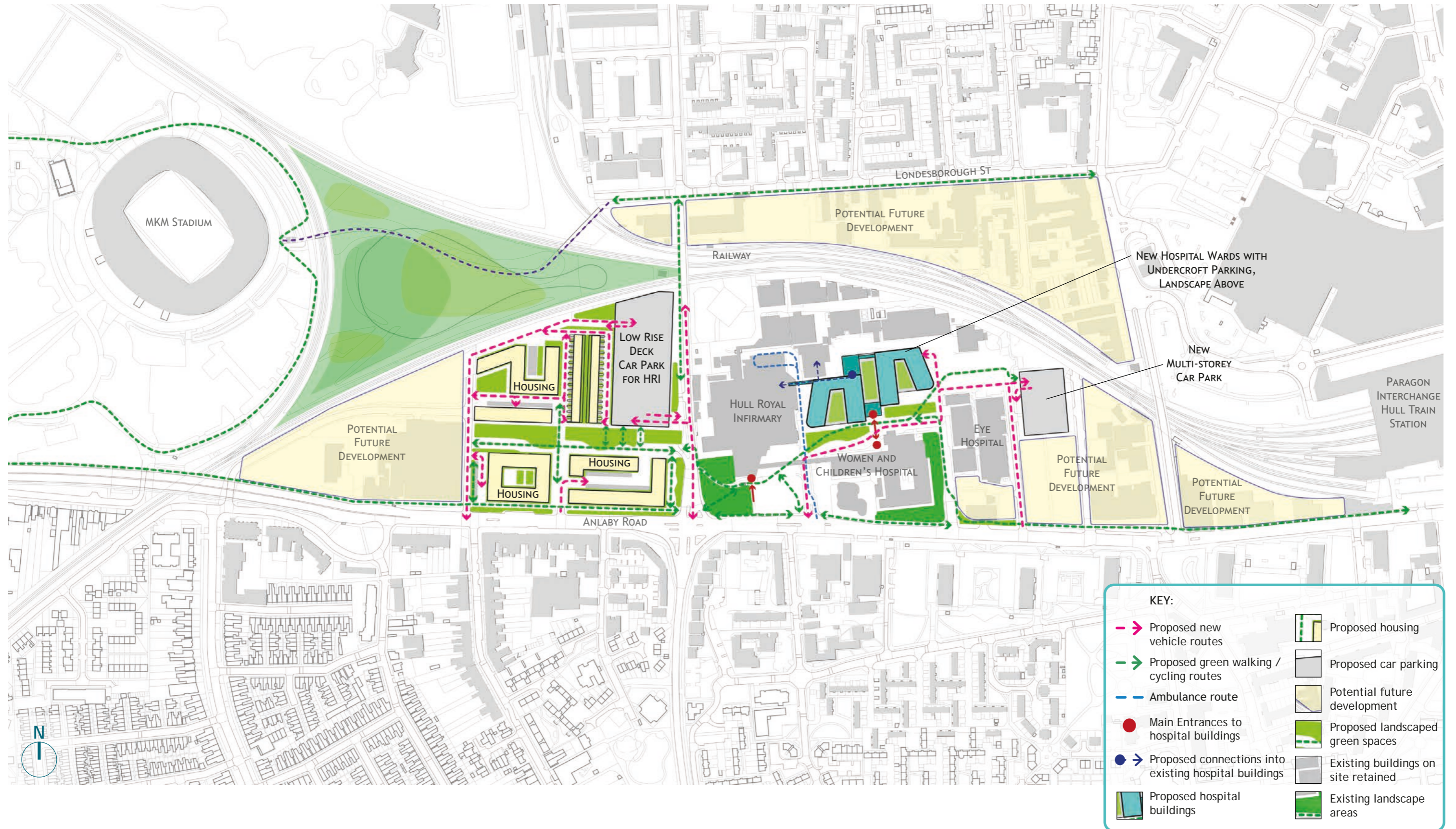

**KEY:**

	Proposed new vehicle routes		Proposed housing
	Proposed green walking / cycling routes		Proposed car parking
	Ambulance route		Potential future development
	Main Entrances to hospital buildings		Proposed landscaped green spaces
	Proposed connections into existing hospital buildings		Existing buildings on site retained
	Proposed hospital buildings		Existing landscape areas

### 4.3.3 Healthcare Proposal

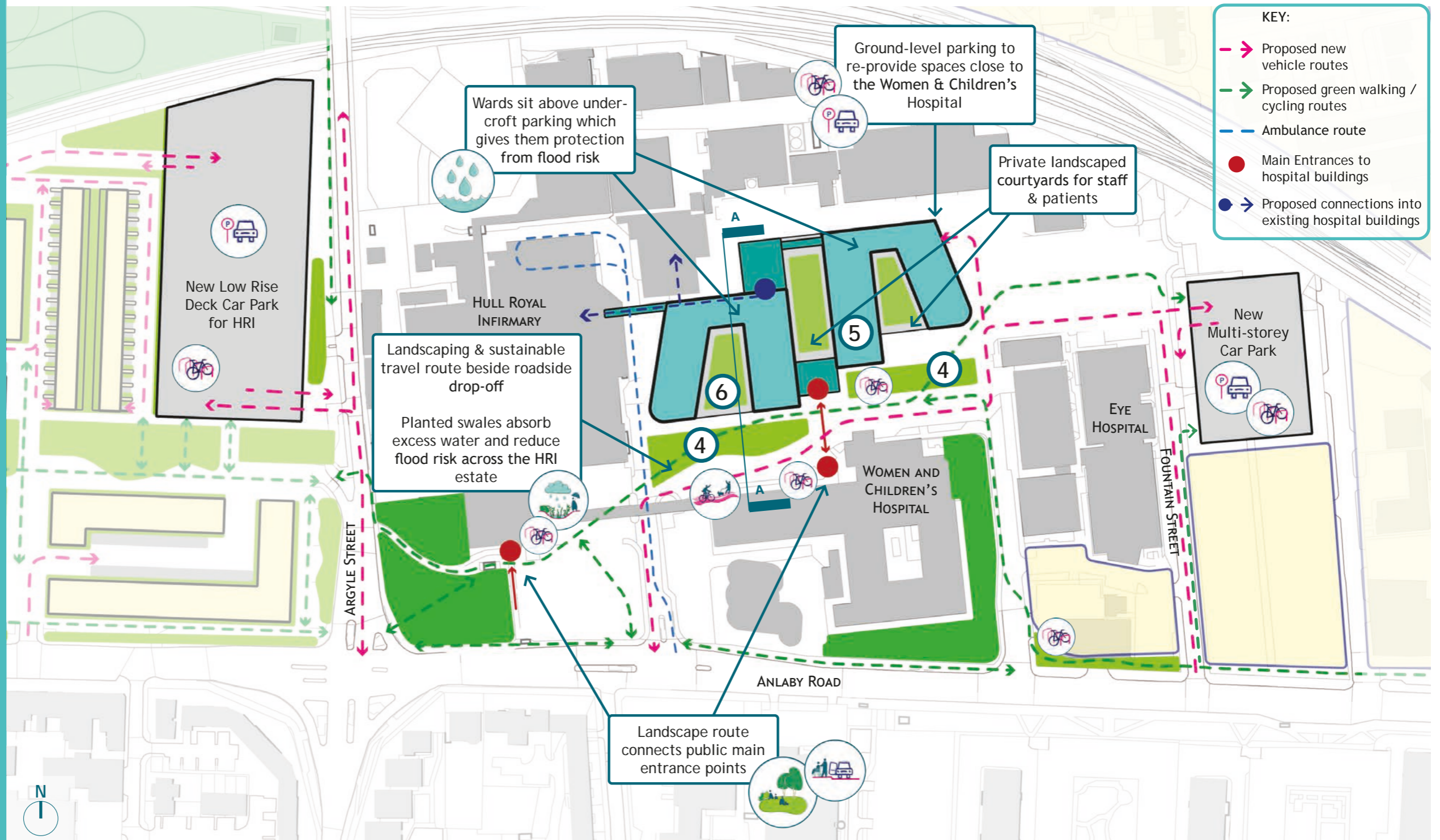

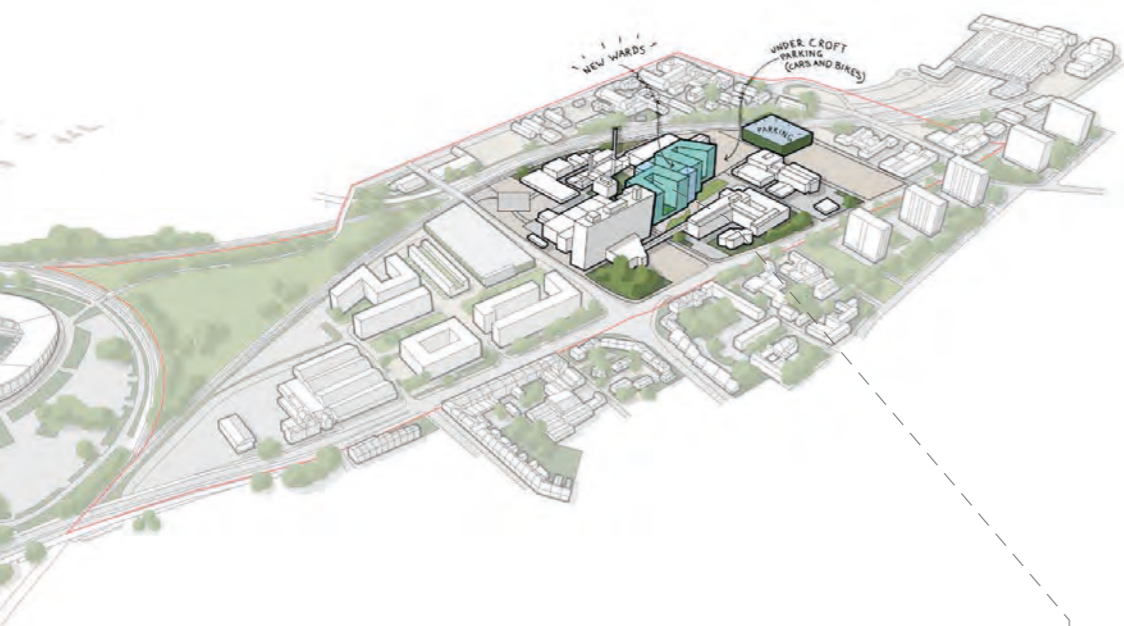

4 Bright Building, Manchester: example of SUDS & greening in public realm

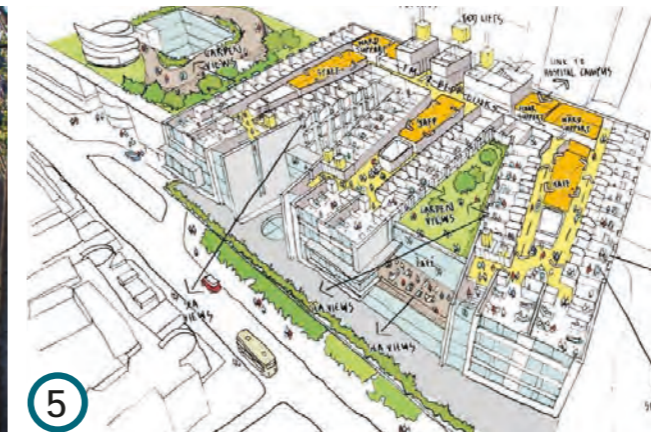

5 Brighton 3T's: precedent where hospital wards were orientated facing garden views



6 Southmead Hospital: example of opportunity for private ward gardens

Precedent Images

Healthcare Site: Key Aims

- Provide high quality accommodation to replace the existing ward tower as part of the Nationwide New Hospital Programme.
- Add green space amenity where possible on the constrained existing estate.
- Create a sustainable travel route across the HRI estate, linking to Anlaby Road but providing a secondary additional route.
- Preserve current surface car-parking numbers where needed, such as those convenient to Women & Children's Hospital.
- Tie new wards into existing key facilities of Theatres, Intensive Care Unit & Imaging.
- Improve existing flood risk to HRI estate and mitigate flood risk to new accommodation.
- Separate the front-of-house entrance space from back-of-house service area.
- Make sustainable travel routes prominent and visible across the site.

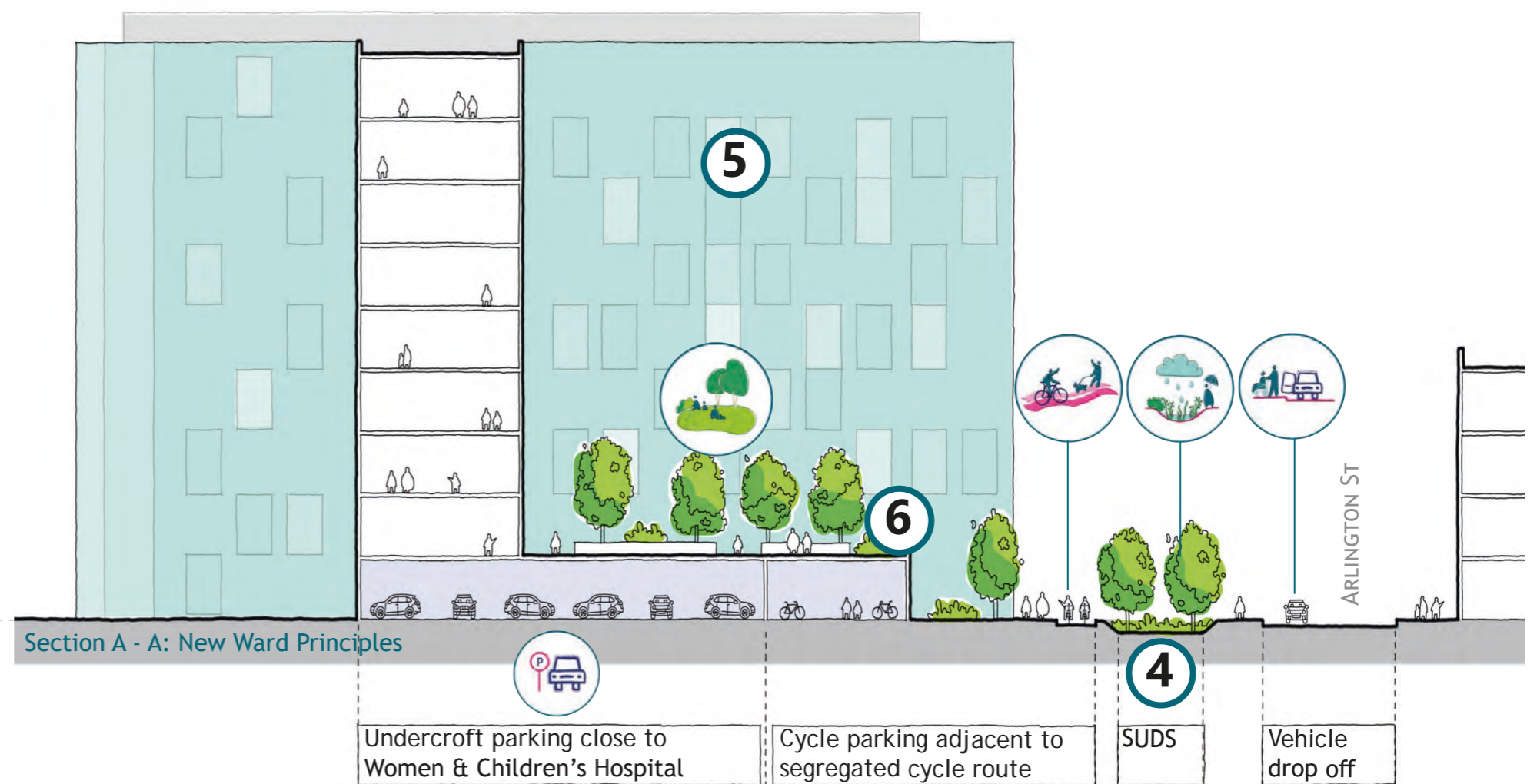

### 4.3.4 Housing Proposal

